



Operating Instructions Wine Cooler

Page 16-29

Many thanks for your trust.

Congratulations on your purchase of this wine cooler. In buying this product, which is distinguished by its perfect user-friendliness, impeccable reliability and high quality, you have chosen a top class appliance. We wish you a lot of pleasure with your new wine cooler – and a lot of enjoyment from your wines.

The fewer the grapes produced in an area, the better the wine.

Poor, well-drained soils are best for good wines. The properties of the soil influence the vitality of the vine, which in turn affects the quality of the grape. Climate is another factor that is important for wine. Because light and air humidity are important for the development of the flavour of the wine.



The right environment for your wines.

A vine is an extremely sensitive plant. From the time it is planted to its maturing period and the time the grapes are harvested and the wine is made, it is dependent on three factors: light, air humidity and ambient temperature. This sensitivity continues even once the wine is bottled. To allow the flavour of the wine to fully develop or to preserve the excellent aroma, the wine has to be stored perfectly – and your wine cooler offers the best conditions for this.

Contents**Page**

Setting up / Dimensions	
Connecting to the mains	
Switching the appliance on and off	
Cooling wine	
Temperature display	18-19
Setting the temperature	
Audible warning signal	
Alarm function of the temperature display	
Interior light	20-21
Humidifier	
Air exchange with activated carbon filter	
Equipment	22-23
Defrosting / Cleaning	
Malfunctions	24-25
Changing over door hinges	
Storage diagrams.....	26-27
Safety instructions and warnings	
Shutting your appliance down	
Environmental protection and disposal notes	
General information	28-29

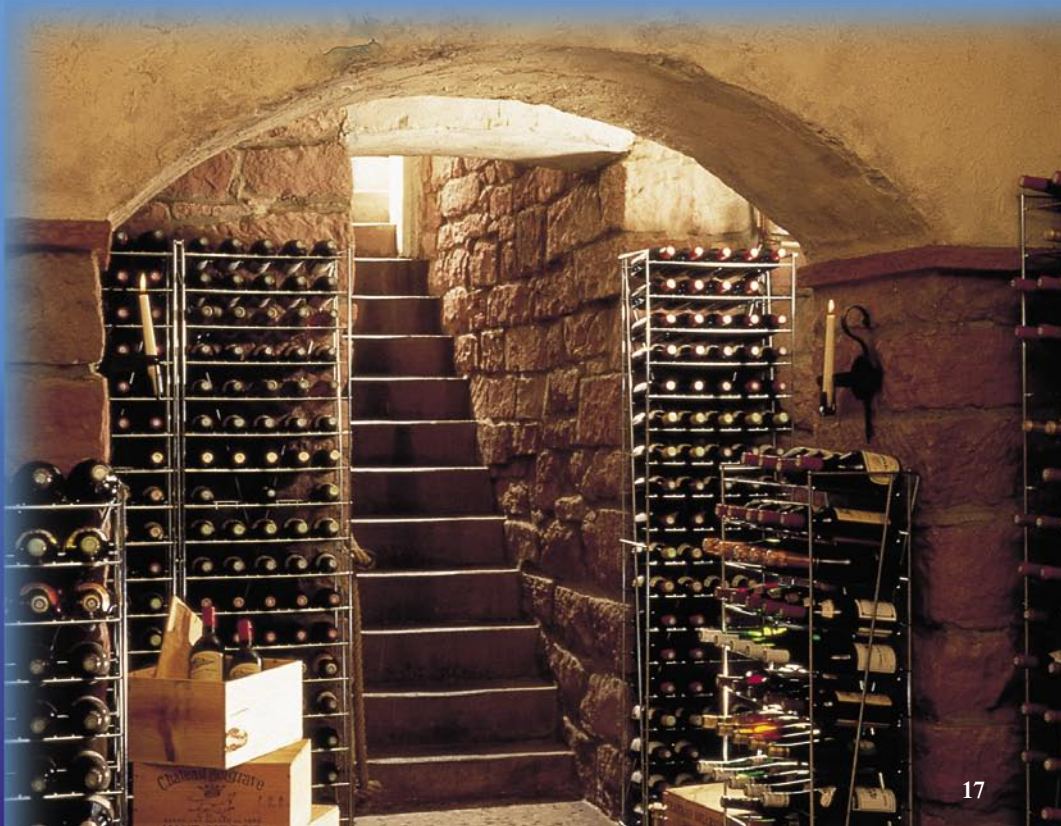

Setting up

- Avoid locating it in direct sunlight or near heat sources such as an oven or a radiator.
- Attach the handle to the side of the door as shown in the illustration in "Changing over door hinges". By fitting the handle yourself you will help to save on packaging material.
- The floor should be level and even. You can compensate for an uneven floor by adjusting the adjustable feet. The appliance can be placed with its back flush to the wall.
- Please make sure the appliance is properly ventilated.
- Standard EN 378 specifies that the room in which you install your appliance must have a volume of 1 m³ per 8 g of R 600a refrigerant used in the appliance, so as to avoid the formation of inflammable gas/air mixtures in the room where the appliance is located in the event of a leak in the refrigerant circuit. The quantity of refrigerant used in your appliance is indicated on the type plate on the inside of the appliance.
- The appliance is set to operate within specific ambient temperature limits according to its climate rating. These temperature limits should not be exceeded. The correct climate rating for your appliance is indicated on the type plate.
SN - ST = + 10° to + 38 °C

Dimensions

height: 1644 mm, width: 659 mm, depth: 683 mm

Connecting to the mains

Power supply (AC) and voltage at the operating point must comply with the details on the type plate. The type plate is located on the top left-hand side on the inside of the appliance. The socket must be fused with a 10 A fuse or higher. Please allow the appliance to stand for approximately 1/2 – 1 hour before you connect it to a properly earthed socket. The socket should be easily accessible and not directly behind the appliance.

Switching the appliance on and off

You are recommended to clean the appliance before switching it on for the first time (see "Cleaning"). The appliance has been tested and is supplied set for normal operation. The appliance will be operational as soon as it is connected to a properly earthed socket. The alarm will sound when the appliance is switched on for the first time and when the appliance is warm. Press the "Alarm" button to switch it off. The temperature display will also flash.

When starting up for the first time or when the appliance is warm, dashes will appear until the temperature reaches a level that can be displayed.

- **To switch the appliance off:** Keep the "ON / OFF" button pressed for 3 sec. so that the temperature display goes out.
- **To switch the appliance on:** Press the "ON / OFF" button until the Display lights up.

Cooling wine

The wine cooler enables you to bring your wines gradually and evenly to the right temperature for drinking in 5 different temperature zones. The table on the left indicates the temperature settings in each compartment, which are pre-set in the factory. The appliance is delivered with the grid shelves in the right positions to achieve these temperatures. The specified temperatures are guide values. Depending on the number of bottles in the appliance, the ambient temperature and the position in the various compartments, the temperatures may differ.

+16°C <> +18°C	
+13°C <> +15°C	
+ 9°C <> +12°C	
+ 7°C <> + 9°C	
+ 5°C <> + 7°C	

Temperature display

The temperature can be displayed for either the top or the bottom compartment. To do this press the „ZONE“ button. The LED ① or ② will show the selected temperature zone



Setting the temperature

The temperature may be adjusted slightly in the top and bottom storage compartment.

Top: +16°C to +18°C.

Bottom: +5°C to +7°C.

The temperatures in the central zones will thus change accordingly.



Select the appropriate compartment by pressing the „ZONE“ button. The appropriate LED ① for the top compartment or ② for the bottom compartment will be lit.

- **To reduce the temperature:** Press the button "DOWN" ▼
 - **To increase the temperature:** Press the button "UP" ▲
- While you are entering the temperature, the set temperature will flash on the display.
 - You can change the settings in increments of 1°C briefly pressing the button again.
 - The electronic controls will switch over automatically about 5 seconds after the last time you pressed the button, and the actual temperature will be displayed.

Display brightness: You can change the brightness if required.

- **To make the display brighter:** Keep the audible warning button pressed and press button ▲ simultaneously.
- **To make the display darker:** Keep the audible warning button pressed and press button ▼ simultaneously.

Audible warning signal

The audible warning signal helps to protect your wines against excessive temperature fluctuations.

- It sounds when the door has been left open for longer than about 180 seconds. The audible warning device is switched off by pressing the "ALARM" button.
- It sounds when the interior gets too warm or too cold. The temperature display will also flash. The audible warning device is switched off by pressing the "ALARM" button. The temperature display will continue to flash until the cause of the alarm has been rectified.

Alarm function of the temperature display

GB

In addition to the audible warning signal the appliance also has a visual alarm function.

- **Temperature in the top compartment too warm or too cold:** The LED ① will be lit and the temperature display will flash. By pressing the “ZONE” button you can check whether the temperature in the bottom compartment is still within the set range. After approx. five seconds the display will return to the “alarm zone”. The display will flash until the alarm status has been rectified.
- **Temperature in the bottom compartment too warm or too cold:** The display will flash and the LED ② will be lit.

If "F1" or "F2" appears in the display, the appliance has a fault. Consult your nearest customer service point, quoting the **type of appliance, index and service number**.

Interior light

This switches off automatically after the door has been opened for approx. 15 minutes. **To change the bulb:** disconnect your wine cooler from the mains. Change the bulb behind the operating panel. **Bulb data:** 15 W. The voltage should agree with the details on the type plate. Socket: E 14.

Interior light in appliances with glass door

The interior light is fitted on the inside at the top. It can be switched on and off by pressing the switch S on the underside of the tabletop.

To change the tube:

- Pull out the mains plug or remove/unscrew the fuse.
- Lever out the cover panel on the lamp housing at the front and remove downwards.
- Turn the tube 90° and pull out downwards. Insert a new tube and turn 90°.
- Replace the cover panel by inserting at the back and clicking into place at the front.

If the interior light still does not work after you have changed the bulb, please consult your nearest customer service point.



Humidifier

The right humidity is vitally important for the proper storage of wine. Your wine cooler is fitted with a special humidifying device that increases the humidity inside the appliance.

Spread out the lava stones provided along the defrost water drain gully along the bottom of the interior. Make sure the drain pipe in the middle is not blocked. Then fill the gully with water up to the top edge of the pipe.

In normal operation, the lava stones are regularly humidified by the defrost water that accumulates in the appliance. Note that if the humidity in the area in which your appliance is installed is particularly high, the interior of your wine cooler will also be relatively more humid. This may result in bottles misting up when the door is opened or labels peeling off.



Air exchange with activated carbon filter

The way in which wines continue to mature depends on the ambient conditions. The quality of the air is therefore decisive for preserving the wine. An activated carbon filter has been fitted in the lower area of the rear wall of the appliance to ensure that the air throughput remains at an optimum quality. We recommend that you replace the filter once a year. Filters can be obtained from your dealer.

Changing the filter: Take the filter by the handle. Turn it 90° to the left or right and remove.

Inserting the filter: Insert with the handle in a vertical position. Turn it 90° to the left or right until it clicks into place.



Equipment

Labels

The appliance is supplied with a label holder with labels for each shelf. Use these to label the type of wine stored on each shelf. Use a soft pencil on the labels so that you can erase it again when necessary. Additional labels can be obtained from your dealer.

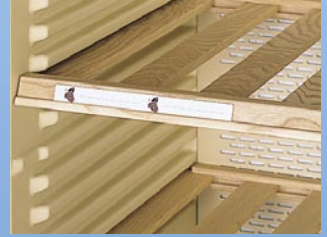

Wooden folding shelf

This shelf can be folded down to allow you to present wine bottles at a slight angle. Pull the empty shelf forwards, pull the front section down over three side support ribs and then push the entire shelf back into position again.



Wooden pull-out shelf

The pull-out shelf allows bottles of wine to be removed more easily. The shelf can be inserted in any position in the appliance.

Proceed as follows:

- Pull the empty shelf out as far as possible.
- Rotate the securing roller through approx. four to five turns backwards as shown in the illustration.
- Remove the entire shelf from the appliance and then insert it again following the above instructions in reverse.



Defrosting

The appliance defrosts automatically. The water that forms on the rear wall drains into a reservoir at the back of the appliance and evaporates automatically through the compressor heat. Make sure that the defrost water can flow freely through the drain opening (see "Cleaning").

Cleaning

Before cleaning always switch off the appliance. Pull out the mains plug or remove/unscrew the fuse.

Never use abrasive or acidic cleaning agents or chemical solvents. We recommend the use of an all-purpose cleaner with neutral pH.

Do not use steam cleaners because of the risk of injury and damage.

- Clean the inside, equipment parts and outer walls with lukewarm water and a little detergent.
- Ensure that no cleaning water penetrates into the electrical components.
- Dry all parts well with a cloth.
- Clean the drain hole in the refrigerator compartment with a thin object, e.g. cotton swab or the like.
- Do not remove the type plate from the inside of the appliance; it is important for after-sales servicing.



Malfunctions

Your appliance is designed and manufactured for a lengthy, reliable operating life with no malfunctions. If a malfunction nonetheless occurs during operation, check whether it is due to an operating error. Please note that even during the warranty period the resultant servicing costs in this case will have to be borne by the owner.

You may be able to rectify the following faults by checking the possible causes yourself:

- **Appliance does not function:**
 - Check that the appliance is properly connected to the mains.
 - Is the socket fuse intact?
- **Loud running noise:** Check that the appliance is standing firmly on the ground. Please note that it is impossible to avoid flowing noises in the refrigeration circuit.
- **The temperature inside your wine cooler is too warm:** Check the setting in accordance with the section "Setting the temperature".
 - Does the separately installed thermometer show the correct reading?
 - Is the air extraction working properly?
 - Is the wine cooler too close to a heat source?
- Please note that, as can happen with other forms of storage, slight mould may form depending on the type of adhesive on the labels. This can be rectified by carefully cleaning any adhesive residues off the bottles.

If none of the above causes apply and you cannot rectify the fault yourself, contact the nearest customer service department stating the type ① of appliance, index ② and service number ③ as indicated on the type plate. The type plate is located on the left-hand inside wall.

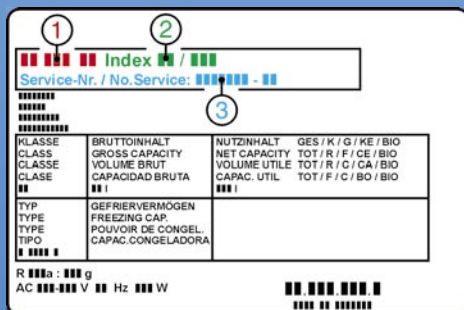

Changing over door hinges

- Close the door and unscrew the hinge bracket ①.
- Pull the door out at the bottom and lift off.
- Unscrew the hinge pin ② from the hinge bracket ① and screw into the adjacent retaining hole.
- Unscrew hinge pin ③ and screw in on opposite side.
- Attach the closure ④ and plugs ⑤ on the opposite side.
- Rotate door by 180°.
- Screw the handle onto the door using the holes provided.
- Lift off the cover ⑥ and seal the exposed retaining holes on the other side with it.
- Mount door on hinge pin ③ and close.
- Insert hinge bracket ① in lower door mounting and screw onto plinth.

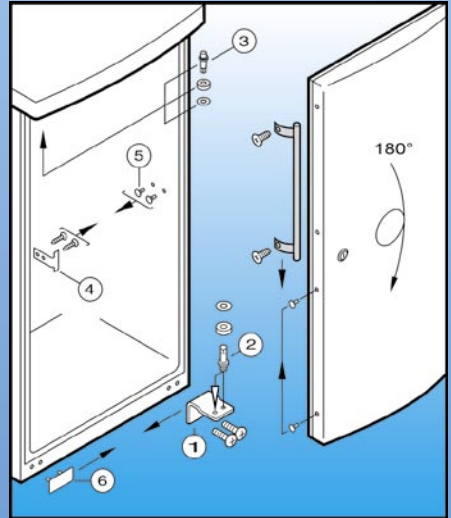

Storage diagrams

for 750 ml Bordeaux bottles

The loading pattern illustrated is only an example: the appliance can be loaded with different quantities depending on how the shelves are arranged.

41 series
Total: 182 bottles

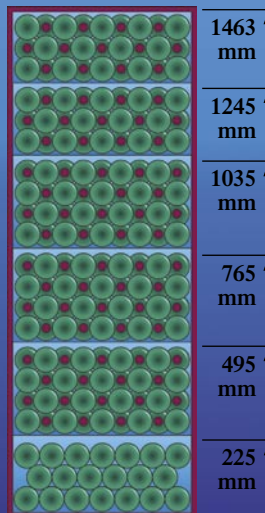

Changing over door hinges

Glass door appliances

- Close the door and unscrew the hinge bracket ①.
- Pull the door out at the bottom and lift off.
- Unscrew the hinge pin ② from the hinge bracket ① and screw into the adjacent retaining hole.
- Unscrew hinge pin ③ and screw in on opposite side.
- Screw the handle onto the door using the holes provided.
- Lift off the cover ⑥ and seal the exposed retaining holes on the other side with it.
- Mount door on hinge pin ③ and close.
- Insert hinge bracket ① in lower door mounting and screw onto plinth.

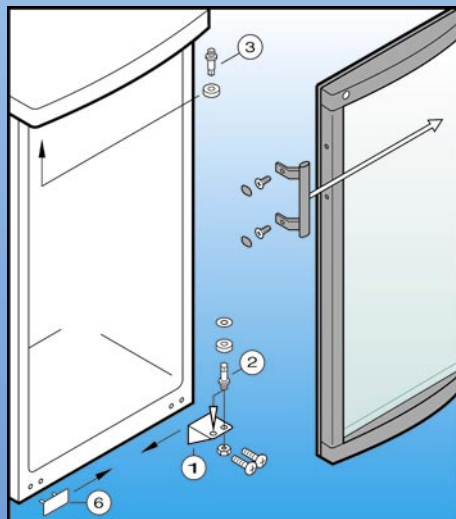

Replacing the door lock

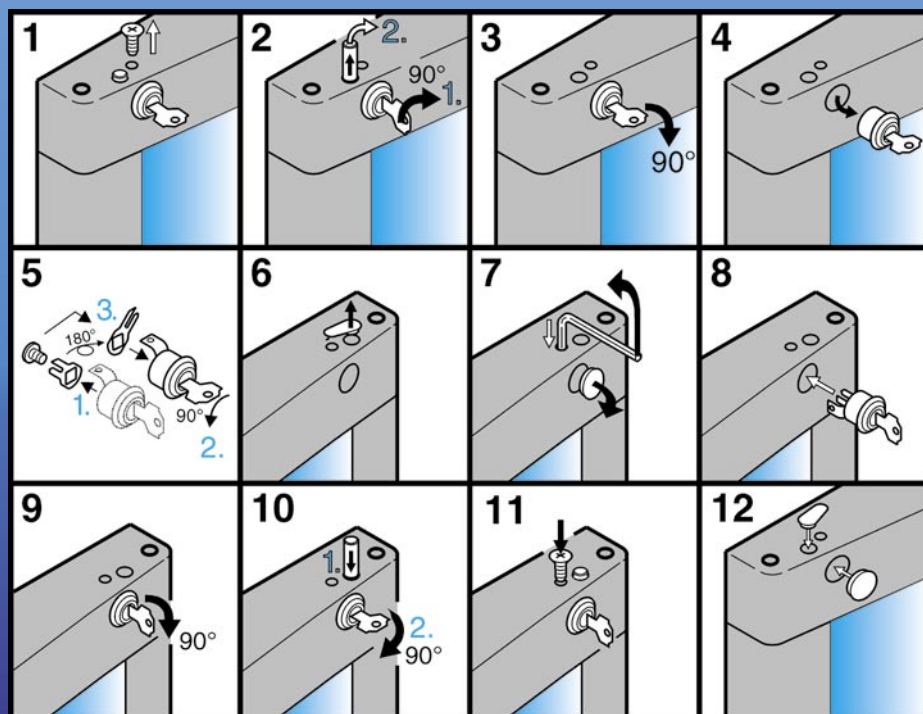

Safety instructions and warnings

- To prevent injury or damage to the unit, the appliance should be unpacked and set up by two people.
- In the event that the appliance is damaged on delivery, contact the supplier immediately before connecting to the mains.
- To guarantee safe operation, ensure that the appliance is set up and connected as described in these operating instructions.
- Disconnect the appliance from the mains if any fault occurs. Pull out the plug, switch off or remove the fuse.
- When disconnecting the appliance, pull on the plug, not on the cable.
- **Any repairs and work on the appliance should only be carried out by the customer service department, as unauthorised work could prove highly dangerous for the user. The same applies to changing the mains power cable.**
- Do not stand on the plinth, drawers or doors or use them to support anything else.
- This appliance is not intended for use by persons (including children) with reduced physical, sensory or mental capabilities or lack of experience and knowledge unless they have been given initial supervision or instruction concerning use of the appliance by a person responsible for their safety. Children should be supervised to ensure that they do not play with the appliance.
- Avoid prolonged skin contact with cold surfaces or chilled/frozen food. This could cause pain, numbness and frostbite. In the case of prolonged skin contact, protective measures should be taken, e.g. gloves should be worn.
- **If you have a lockable appliance, do not keep the key near the appliance or within reach of children.**
- Do not use electrical appliances inside the appliance.

Shutting your appliance down

If your appliance is to be shut down for any length of time, switch it off and disconnect the plug or remove the fuse. Clean the appliance and leave the door open in order to prevent unpleasant smells.



Environmental protection and disposal notes

The packaging is designed to protect the appliance and individual components during transport and is made of recyclable materials.

- corrugated cardboard/cardboard (predominantly recycled paper)
- moulded polystyrene (foamed, CFC-free polystyrene)
- polyethylene bags and sheets
- polypropylene straps
- Please return the packaging material to the nearest official collection point so that the various materials can be recycled or reused as far as possible and so as to avoid throwing them away.

Old appliances still contain reusable materials and should not be disposed of with household or bulk refuse.

- Disable discarded appliances immediately by removing the plug and cutting through the connection cable.
- **Remove the spring-action or bolt catch from the appliance or render it unusable so that children cannot become trapped inside and suffocate.**
- Ensure that the refrigerant circuit and in particular the heat exchanger on the rear of the appliance is not damaged before the appliance that is no longer needed is taken away for disposal. In this way the refrigerant will not escape into the environment.
 - Information concerning the refrigerant and insulating materials used can be found on the type plate.
 - Information on collection dates or collection points can be obtained from the waste disposal authorities or local council.

General information

The refrigerant circuit has been tested for leaks.

The appliance is radio-suppressed to EN 55014 and thus complies with EC Directive 87/308/EEC.

All types and models are subject to continuous improvement and the manufacturer therefore reserves the right to make modifications to the shape, equipment and technology.