



Operating Instructions Wine storage refrigerator

Page 14-25

Many thanks for your trust.

Congratulations on your purchase of this wine storage refrigerator. In buying this product, which is distinguished by its perfect user-friendliness, impeccable reliability and high quality, you have chosen a top class appliance. We wish you a lot of pleasure with your new wine storage refrigerator – and a lot of enjoyment from your wines.

The fewer the grapes produced in an area, the better the wine.

Poor, well-drained soils are best for good wines. The properties of the soil influence the vitality of the vine, which in turn affects the quality of the grape. Climate is another factor that is important for wine. Because light and air humidity are important for the development of the flavour of the wine.



The right environment for your wines.

A vine is an extremely sensitive plant. From the time it is planted to its maturing period and the time the grapes are harvested and the wine is made, it is dependent on three factors: light, air humidity and ambient temperature. This sensitivity continues even once the wine is bottled. To allow the flavour of the wine to fully develop or to preserve the excellent aroma, the wine has to be stored perfectly – and your wine storage refrigerator offers the best conditions for this.

Contents

Page

Setting up
 Dimensions
 Connecting to the mains
 Switching the appliance on and off
 Setting the temperature
 Storing wine
 Loading
 Air exchange with activated carbon filter..... 16-17
 Labels
 Interior light
 Defrosting
 Cleaning 18-19
 Malfunctions
 Storage diagrams..... 20-21
 Changing over door hinges..... 22-23
 Safety instructions and warnings
 Shutting your appliance down
 Environmental protection and disposal notes
 General information 24-25

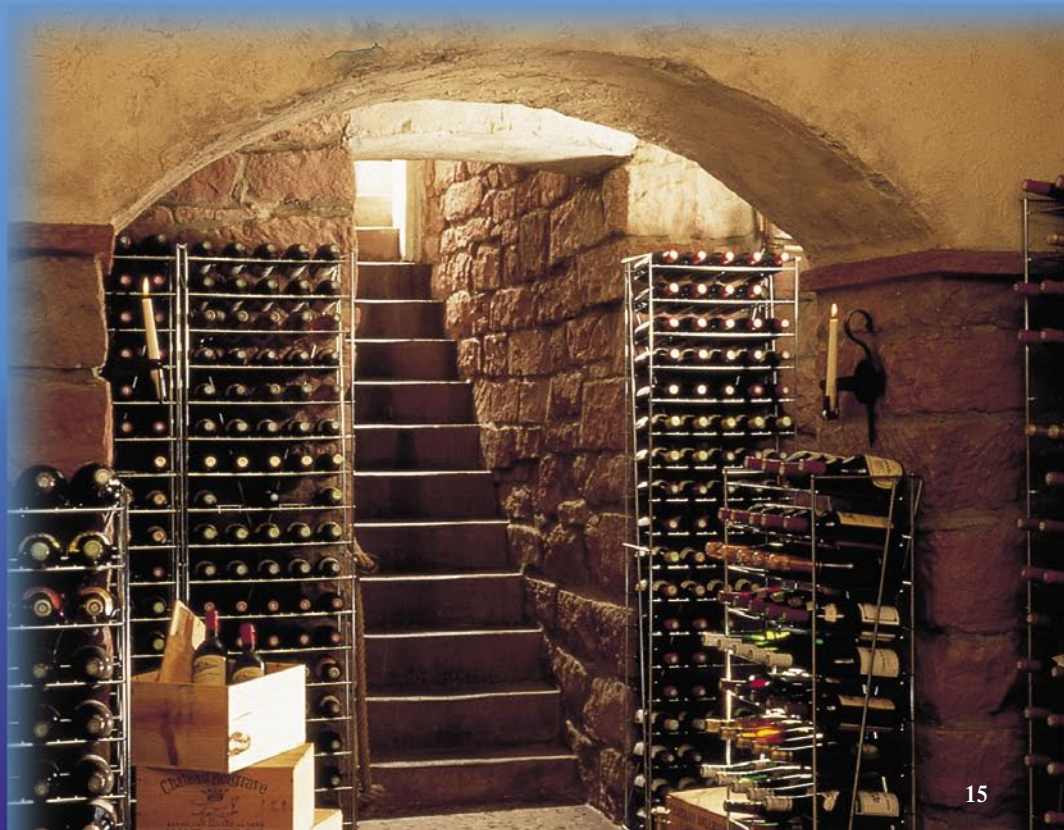

Setting up

- The temperature in the place where your wine storage refrigerator is located must be between 8° and 43°C (Glass door appliances 10° - 38° C).
Avoid locating it in direct sunlight or near heat sources such as an oven or a radiator.
- Attach the handle to the side of the door as shown in the illustration in "Changing over door hinges". By fitting the handle yourself you will help to save on packaging material.
- The floor should be level and even. You can compensate for an uneven floor by adjusting the adjustable feet. The appliance can be placed with its back flush to the wall.
- Please make sure the appliance is properly ventilated.
- Standard EN 378 specifies that the room in which you install your appliance must have a volume of 1 m³ per 8 g of R 600a refrigerant used in the appliance, so as to avoid the formation of inflammable gas/air mixtures in the room where the appliance is located in the event of a leak in the refrigerant circuit. The quantity of refrigerant used in your appliance is indicated on the type plate on the inside of the appliance.

Dimensions

Series 18: height: 884 mm, width: 602 mm, depth: 631 mm

Series 29: height: 1250 mm, width: 659 mm, depth: 683 mm

Series 41: height: 1644 mm, width: 659 mm, depth: 683 mm

Series 46: height: 1841 mm, width: 659 mm, depth: 683 mm

Series 57: height: 1705 mm, width: 755 mm, depth: 720 mm

Connecting to the mains

Power supply (AC) and voltage at the operating point must comply with the details on the type plate. The type plate is located on the top left-hand side on the inside of the appliance. The socket must be fused with a 10 A fuse or higher.

Please allow the appliance to stand for approximately 1/2 – 1 hour before you connect it to a properly earthed socket. The socket should be easily accessible and not directly behind the appliance.

Switching the appliance on and off

You are recommended to clean the appliance before switching it on for the first time (see "Cleaning"). The appliance has been tested and is supplied set for normal operation. The appliance will be operational as soon as it is connected to a properly earthed socket.

- **To switch the appliance off:** pull out the mains plug or remove/unscrew the fuse.

Setting the temperature

Using a coin, turn the arrow on the temperature control to a setting between "1" and "7".

Setting "1" = lowest cooling setting, highest temperature

Setting "7" = highest cooling setting, lowest temperature

Storing wine

If you are storing wine for long periods of time, it should be stored at a temperature of between 10°C and 14°C. This is the temperature wine cellars are kept at, and it is just right to allow wine to mature properly. Try to store bottles of the same sort of wine next to each other on the same shelf so as to avoid having to move other bottles to access the bottles you want to remove, as wine should not be moved during storage if at all possible.

Loading

The enclosed plan gives you various options for loading your wine storage refrigerator. NB: the appliance is fitted with flexible grid shelves which may sag slightly when fully loaded. However this will not affect the safety of your stored wines.

Air exchange with activated carbon filter

The way in which wines continue to mature depends on the ambient conditions. The quality of the air is therefore decisive for preserving the wine. An activated carbon filter has been fitted in the lower area of the rear wall of the appliance to ensure that the air throughput remains at an optimum quality.

We recommend that you replace the filter once a year. Filters can be obtained from your dealer.

Changing the filter: Take the filter by the handle. Turn it 90° to the left or right and remove.

Inserting the filter: Insert with the handle in a vertical position. Turn it 90° to the left or right until it clicks into place.



Labels

(depending on equipment)

The appliance is supplied with a label holder with labels for each shelf. Use these to label the type of wine stored on each shelf. Use a soft pencil on the labels so that you can erase it again when necessary.

Additional labels (with holders if required) can be obtained from your dealer.

- **Installation:** Snap the label holder into position (fig. A) and insert the label from the top.
- **Fitting onto wooden shelves:** Insert the labels from above as illustrated in fig. B.



fig. A



fig. B

Interior light in appliances with glass door

The interior light is fitted on the inside at the top. It can be switched on and off by pressing the switch S on the underside of the tabletop.

To change the tube:

- Pull out the mains plug or remove/unscrew the fuse.
- Lever out the cover panel on the lamp housing at the front and remove downwards.
- Turn the tube 90° and pull out downwards. Insert a new tube and turn 90°.
- Replace the cover panel by inserting at the back and clicking into place at the front.

If the interior light still does not work after you have changed the bulb, please consult your nearest customer service point.



Defrosting

The appliance defrosts automatically. The water that forms on the rear wall drains into a reservoir at the back of the appliance and evaporates automatically through the compressor heat. Make sure that the defrost water can flow freely through the drain opening (see "Cleaning").

Cleaning

Before cleaning always switch off the appliance. Pull out the mains plug or remove/unscrew the fuse.

Never use abrasive or acidic cleaning agents or chemical solvents. We recommend the use of an all-purpose cleaner with neutral pH.

Do not use steam cleaners because of the risk of injury and damage.

- Clean the inside, equipment parts and outer walls with lukewarm water and a little detergent.
- Ensure that no cleaning water penetrates into the electrical components.
- Dry all parts well with a cloth.
- Clean the drain hole in the refrigerator compartment with a thin object, e.g. cotton swab or the like.
- Do not remove the type plate from the inside of the appliance; it is important for after-sales servicing.

Malfunctions

Your appliance is designed and manufactured for a lengthy, reliable operating life with no malfunctions. If a malfunction nonetheless occurs during operation, check whether it is due to an operating error. Please note that even during the warranty period the resultant servicing costs in this case will have to be borne by the owner.

You may be able to rectify the following faults by checking the possible causes yourself:

- **Appliance does not function:**

- Check that the appliance is properly connected to the mains.
- Is the socket fuse intact?

- **Loud running noise:**

- Check that the appliance is standing firmly on the ground. Please note that it is impossible to avoid flowing noises in the refrigeration circuit.

- **The temperature inside your wine storage refrigerator is too warm:** Check the setting in accordance with the section "Storing wine".

- Does the separately installed thermometer show the correct reading?
- Is the air extraction working properly?
- Is the wine storage refrigerator too close to a heat source?

- Please note that, as can happen with other forms of storage, slight mould may form depending on the type of adhesive on the labels. This can be rectified by carefully cleaning any adhesive residues off the bottles.

If none of the above causes apply and you cannot rectify the fault yourself, contact the nearest customer service department stating the type ① of appliance, index ② and service number ③ as indicated on the type plate. The type plate is located on the left-hand inside wall.

The diagram shows a type plate with three numbered callouts: 1 points to the index (red bars), 2 points to the service number (blue bars), and 3 points to the table of technical specifications.

KLASSE	BRUTTOINHALT	NUTZINHALT	GES / K / G / KE / BIO
CLASSE	GROSS CAPACITY	NET CAPACITY	TOT / R / F / CE / BIO
CLASSE	VOLUME BRUT	VOLUME UTILE	TOT / R / C / CA / BIO
CLASSE	CAPACIDAD BRUTA	CAPAC. UTIL	TOT / F / C / BO / BIO
II	II I	III I	
TYP	GEFRIERVERMOGEN		
TYPE	FREEZING CAP.		
TIPO	POUVOIR DE CONGEL.		
II	CAPAC. CONGELADORA		

R IIIa : III g
AC III-III V II Hz III W

Storage diagrams

for 750 ml Bordeaux bottles

The loading pattern illustrated is only an example: the appliance can be loaded with different quantities depending on how the shelves are arranged.

18 series
Total: 68 bottles

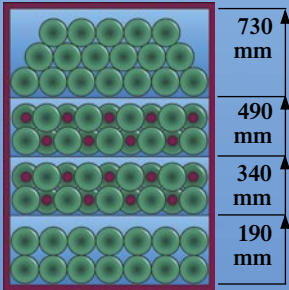

29 series
Total: 115 bottles

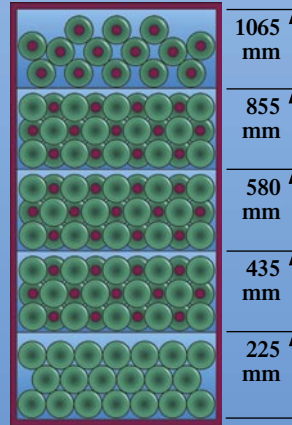

41 series
Total: 169 bottles

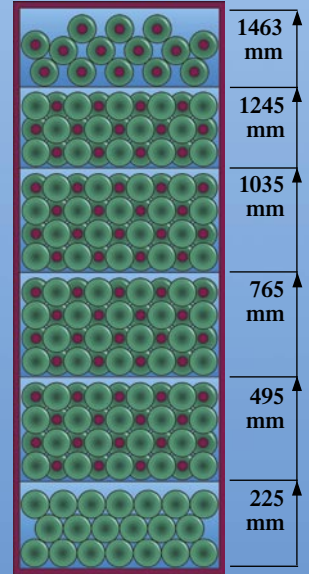

46 series
Total: 196 bottles

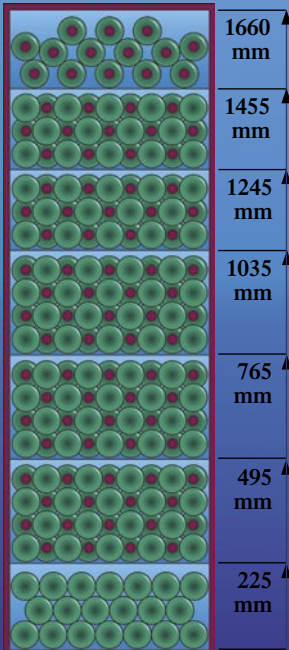

57 series
Total: 231 bottles



Changing over door hinges

- Close the door and unscrew the hinge bracket ①.
- Pull the door out at the bottom and lift off.
- Unscrew the hinge pin ② from the hinge bracket ① and screw into the adjacent retaining hole.
- Unscrew hinge pin ③ and screw in on opposite side.
- Attach the closure ④ and plugs ⑤ on the opposite side.
- Rotate door by 180°.
- Screw the handle onto the door using the holes provided.
- Lift off the cover ⑥ and seal the exposed retaining holes on the other side with it.
- Mount door on hinge pin ③ and close.
- Insert hinge bracket ① in lower door mounting and screw onto plinth.

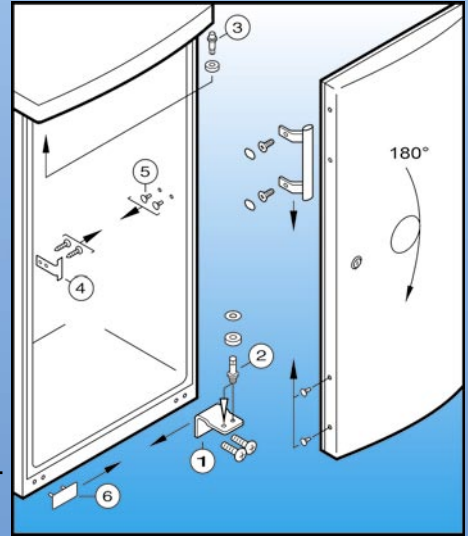

Changing over door hinges Glass door appliances

- Close the door and unscrew the hinge bracket ①.
- Pull the door out at the bottom and lift off.
- Unscrew the hinge pin ② from the hinge bracket ① and screw into the adjacent retaining hole.
- Unscrew hinge pin ③ and screw in on opposite side.
- Screw the handle onto the door using the holes provided.
- Lift off the cover ⑥ and seal the exposed retaining holes on the other side with it.
- Mount door on hinge pin ③ and close.
- Insert hinge bracket ① in lower door mounting and screw onto plinth.

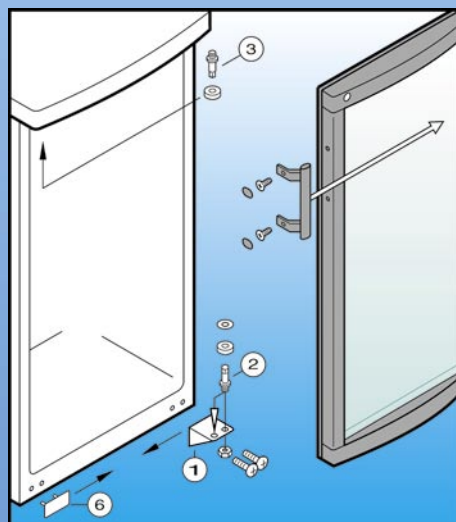

Replacing the door lock

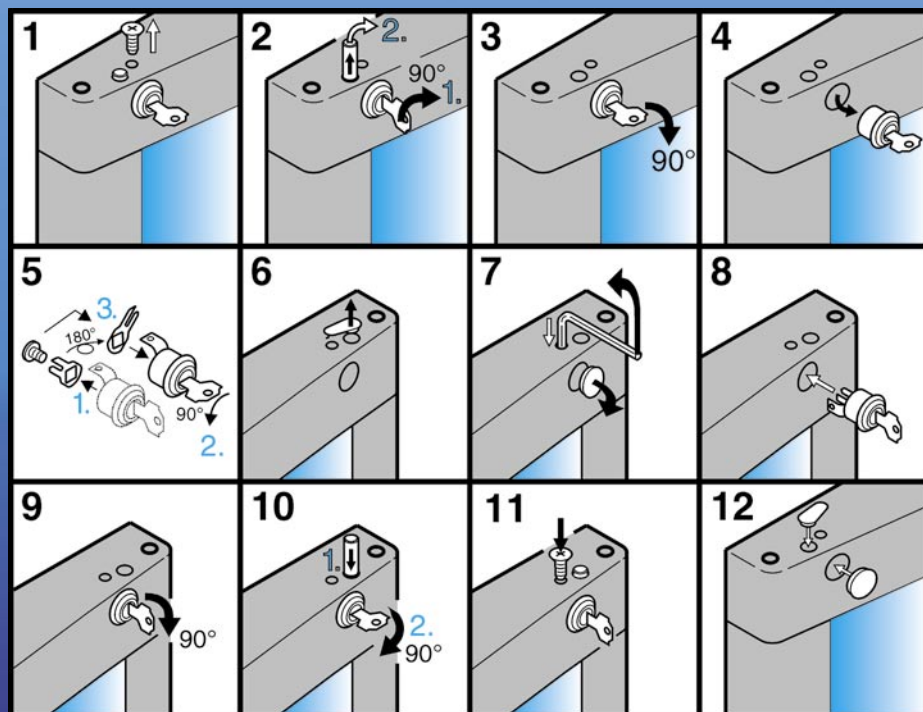

Safety instructions and warnings

- To prevent injury or damage to the unit, the appliance should be unpacked and set up by two people.
- In the event that the appliance is damaged on delivery, contact the supplier immediately before connecting to the mains.
- To guarantee safe operation, ensure that the appliance is set up and connected as described in these operating instructions.
- Disconnect the appliance from the mains if any fault occurs. Pull out the plug, switch off or remove the fuse.
- When disconnecting the appliance, pull on the plug, not on the cable.
- **Any repairs and work on the appliance should only be carried out by the customer service department, as unauthorised work could prove highly dangerous for the user. The same applies to changing the mains power cable.**
- Do not stand on the plinth, drawers or doors or use them to support anything else.
- This appliance is not intended for use by persons (including children) with reduced physical, sensory or mental capabilities or lack of experience and knowledge unless they have been given initial supervision or instruction concerning use of the appliance by a person responsible for their safety. Children should be supervised to ensure that they do not play with the appliance.
- Avoid prolonged skin contact with cold surfaces or chilled/frozen food. This could cause pain, numbness and frostbite. In the case of prolonged skin contact, protective measures should be taken, e.g. gloves should be worn.
- **If you have a lockable appliance, do not keep the key near the appliance or within reach of children.**
- Do not use electrical appliances inside the appliance.

Shutting your appliance down

If your appliance is to be shut down for any length of time, switch it off and disconnect the plug or remove the fuse. Clean the appliance and leave the door open in order to prevent unpleasant smells.

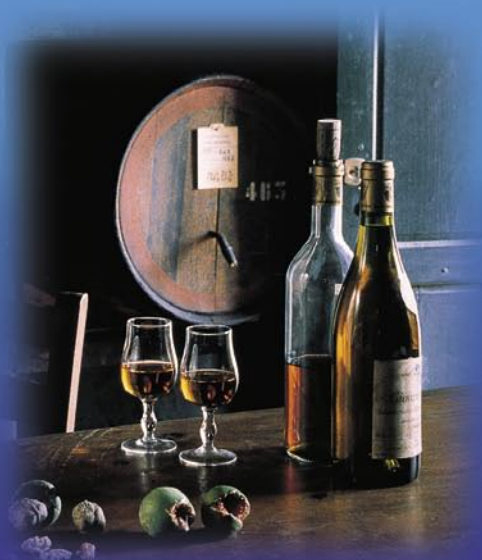

Disposal notes

The packaging is made of recyclable materials.

- Corrugated board/board
- EPS moulded parts
- Polythene sheets
- Polypropylene straps
- **Keep packaging materials away from children - polythene sheets and bags can suffocate!**
- Please return the packaging material to an official collection point.

Your old appliance: This contains some reusable materials and should be disposed of properly - not simply with unsorted household refuse.

- Disable discarded appliances by removing the plug and cutting through the connection cable. Render the catch unusable so that children cannot become trapped inside.
- Make sure that the refrigerant circuit of an appliance that is no longer needed is not damaged before it is collected or handed in at a municipal collection point.
- Details of the refrigerant used can be found on the type plate.
- Information on collection dates or collection points can be obtained from the waste disposal authorities or local council.

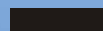

General information

The refrigerant circuit has been tested for leaks.

The appliance is radio-suppressed to EN 55014 and thus complies with EC Directive 87/308/EEC.

All types and models are subject to continuous improvement and the manufacturer therefore reserves the right to make modifications to the shape, equipment and technology.